

MEGAMAN® MARCO Mini

FTK70000v0+012D, FTK70000v0+024D, FTK70000v0+036D, FTA70000v0+012D, FTA70000v0+024D,
FTA70000v0+036D, FTK70000v0-r9+012D, FTK70000v0-ru+024D, FTK70000v0-ru+036D,
FTK70000v0-ru+036D, FTA70000v0-r9+012D, FTA70000v0-ru+024D, FTA70000v0-ru+036D



Instruction Manual | Bedienungsanleitung | Manual de instrucciones | Manuale d'istruzioni | Manuel d'instructions
Handleiding | Návod k použití



GLOBAL
pro 3-circuit track



www.megaman.cc/user-guide



A1



LA10034 (Optional)
1 pcs

A2



1 pcs

A3



LA10087 (Optional)
1 pcs

A4



1 pcs

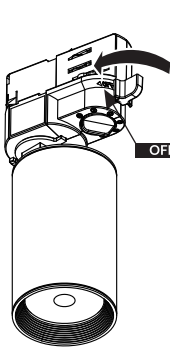

A1/A3

A2/A4

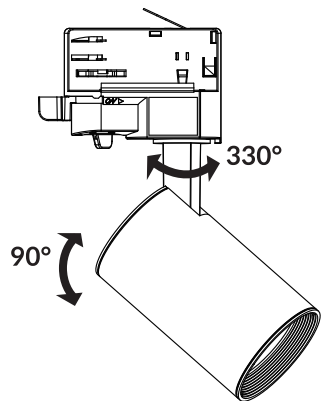
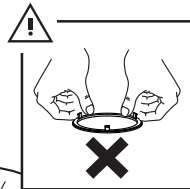
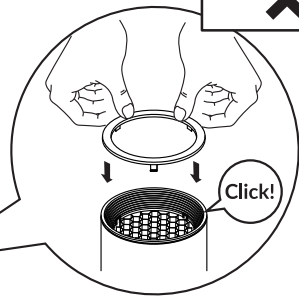
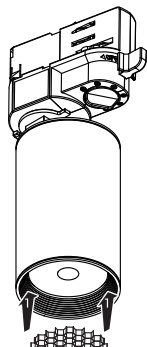

	LA10034	LA10087
FTK70000v0+012D FTK70000v0-r9+012D FTA70000v0+012D FTA70000v0-r9+012D	✗	OK
FTK70000v0+024D FTK70000v0+036D FTK70000v0-ru+024D FTK70000v0-ru+036D	OK	✗

FTK70000v0+012D
FTK70000v0+024D
FTK70000v0+036D
FTK70000v0-r9+012D
FTK70000v0-ru+024D
FTK70000v0-ru+036D

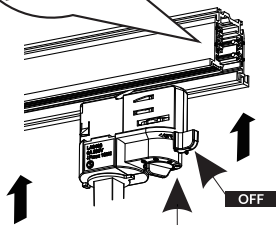
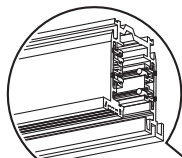

0/1/2/3

OFF

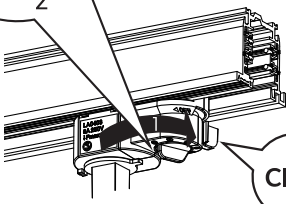

Click!

MEGAMAN® MARCO Mini

FTK70000v0+012D, FTK70000v0+024D, FTK70000v0+036D, FTA70000v0+012D, FTA70000v0+024D, FTA70000v0+036D, FTK70000v0-r9+012D, FTK70000v0-ru+024D, FTK70000v0-ru+036D, FTK70000v0-ru+036D, FTA70000v0-r9+012D, FTA70000v0-ru+024D, FTA70000v0-ru+036D

MEGAMAN®

Instruction Manual | Bedienungsanleitung | Manual de instrucciones | Manuale d'istruzioni | Manuel d'instructions |
Handleiding | Návod k použití





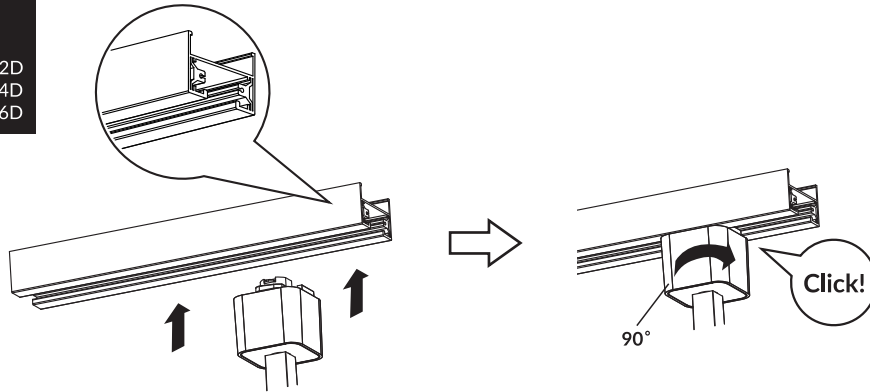

FTA70000v0+012D
FTA70000v0+024D
FTA70000v0+036D
FTA70000v0-r9+012D
FTA70000v0-ru+024D
FTA70000v0-ru+036D

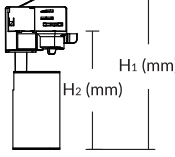
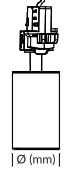

Caution - The light source of this luminaire is not replaceable; when the light source reaches its end of life the whole luminaire shall be replaced.
Vorsicht - Das Leuchtmittel dieser Leuchte ist nicht austauschbar. Ist das Ende der Lebensdauer des Leuchtmittels erreicht, muss die gesamte Leuchte ausgetauscht werden.
ATENCIÓN - La fuente de iluminación de esta luminaria no se puede sustituir; cuando la fuente de iluminación alcance el final de su vida útil, se deberá sustituir la luminaria completa.
Attenzione - La sorgente luminosa di questo apparecchio non è sostituibile; quando la sorgente luminosa giunge al termine della vita operativa, sostituire l'intero apparecchio.
ATTENTION - La source lumineuse de ce luminaire n'est pas remplaçable; lorsque la source lumineuse atteint sa fin de sa vie, le luminaire entier doit être remplacé.
Voorzichtig - De lichtbron van deze lamp kan niet worden vervangen; wanneer de lichtbron het einde van zijn levensduur bereikt heeft, moet de hele lamp worden vervangen.
POZOR! - Zdroj světla v tomto svítidle není vyměnitelný. Jakmile uplyne jeho doba životnosti - svítidlo jako celek by mělo být vyměněno.

The luminaire is only to be installed outside arms reach.
Bauen Sie die Leuchte nicht für Personen erreichbar ein.
La luminaria Debe instalarse únicamente fuera del alcance de la mano.
Installare fuori dalla portata.
Peut seulement être installé en dehors du volume d'accessibilité au toucher.
De lamp mag alleen worden geïnstalleerd buiten armbereik.
Svítidlo instalujte mimo dosah osob.

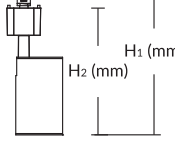
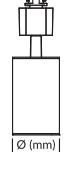
	P	I				CRI
FTK70000v0+012D	12W	58mA	H ₁ 160 H ₂ 124	Ø50	12°	≥Ra80
FTK70000v0+024D	12W	58mA	H ₁ 160 H ₂ 124	Ø50	24°	≥Ra80
FTK70000v0+036D	12W	58mA	H ₁ 160 H ₂ 124	Ø50	36°	≥Ra80
FTK70000v0-r9+012D	12W	58mA	H ₁ 160 H ₂ 124	Ø50	12°	≥Ra90
FTK70000v0-ru+024D	12W	58mA	H ₁ 160 H ₂ 124	Ø50	24°	Ra97
FTK70000v0-ru+036D	12W	58mA	H ₁ 160 H ₂ 124	Ø50	36°	Ra97

	P	I				CRI
FTA70000v0+012D	12W	58mA	H ₁ 145 H ₂ 135	Ø50	12°	≥Ra80
FTA70000v0+024D	12W	58mA	H ₁ 145 H ₂ 135	Ø50	24°	≥Ra80
FTA70000v0+036D	12W	58mA	H ₁ 145 H ₂ 135	Ø50	36°	≥Ra80
FTA70000v0-r9+012D	12W	58mA	H ₁ 145 H ₂ 135	Ø50	12°	≥Ra90
FTA70000v0-ru+024D	12W	58mA	H ₁ 145 H ₂ 135	Ø50	24°	Ra97
FTA70000v0-ru+036D	12W	58mA	H ₁ 145 H ₂ 135	Ø50	36°	Ra97

220-
240V~

50/60
Hz

λ
>0.9

Ta
-30°C ~ +40°C

IP20



8010G0288C
Ver.2018.01_V1

MEGAMAN®