

LED Floodlight Installation Guide

WARNING:

- THE PRODUCT MUST BE INSTALLED BY A QUALIFIED ELECTRICIAN.
- THE POWER SUPPLY MUST BE TURNED OFF BEFORE INSTALLATION.
- NO WARRANTY WILL BE ACCEPTED IF THIS PRODUCT IS NOT INSTALLED BY A QUALIFIED ELECTRICIAN.
- THE LIGHT SOURCE CONTAINED IN THIS LUMINAIRE SHALL ONLY BE REPLACED BY THE MANUFACTURER OR HIS SERVICE AGENT OR A SIMILAR QUALIFIED PERSON.
- DO NOT OPERATE THE PRODUCT WITH A DAMAGED TEMPERED GLASS; THE DAMAGED TEMPERED GLASS SHOULD BE REPLACED BY THE SERVICE AGENT.
- THE DRIVER CAN'T BE REPLACED.
- WHEN PRODUCTS ARE INSTALLED IN HIGH WIND ENVIRONMENTS, APPROPRIATE INSTALLATION/ FASTENING METHODS MUST BE APPLIED SO THAT THE PRODUCT MOUNTING POINTS ARE NOT DAMAGED DUE TO VIBRATION, MOVEMENT OR CORROSION.
- GOOD PRACTICE DOES NOT RECOMMEND CONTINUOUS USE WITHOUT APPROPRIATE SWITCHING CYCLES.
- THE LIGHT SOURCE OF THIS LUMINAIRE IS NOT REPLACEABLE; WHEN THE LIGHT SOURCE REACHES ITS END OF LIFE THE WHOLE LUMINAIRE SHALL BE REPLACED.
- THE EXTERNAL FLEXIBLE CABLE OR CORD OF THIS LUMINAIRE CANNOT BE REPLACED; IF THE CORD IS DAMAGED, THE LUMINAIRE SHALL BE DESTROYED.
- THE TERMINAL IS RATED VOLTAGE IS 300V, RATED CURRENT IS 3A, THE WIRING IS NOT LESS THAN 3x1.0MM.



Product Specification

RÉF.	Size(mm) a*b*c	Wattage (W)	Color Temp (K)	Initial Lumens (lm)	Voltage (V)	Frequency (Hz)	Ta (°C)	PF	Project Area (mm²)
COP-MID-75-FB	355*245*91	75	4000/5000/6500	10000	AC220-240	50	50	0.95	40000
COP-MID-95-FB	403*295*91	95	4000/5000/6500	12800	AC220-240	50	50	0.95	60000
COP-MID-110-FB	403*295*91	110	4000/5000/6500	14850	AC220-240	50	50	0.95	60000
COP-MID-135-FB	431*330*91	135	4000/5000/6500	18200	AC220-240	50	50	0.95	76000
COP-MID-200-FB	471*360*91	200	4000/5000/6500	27000	AC220-240	50	50	0.95	96000

Installation of LED Floodlight

1



1. Disconnect mains supply before installation.

2

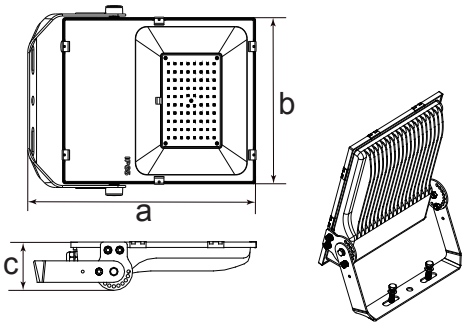

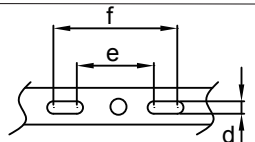

RÉF.	a(mm)	b(mm)	c(mm)	d(mm)	e(mm)	f(mm)
COP-MID-75-FB	355	245	91	11.5	90	150
COP-MID-95-FB	403	295	91	11.5	90	150
COP-MID-110-FB	403	295	91	11.5	90	150
COP-MID-135-FB	431	330	91	11.5	180	240
COP-MID-200-FB	470	360	91	11.5	180	240

2. Drill two holes in the installation location, then fix the product in the location with screws. Distance between holes are in the chart.

3

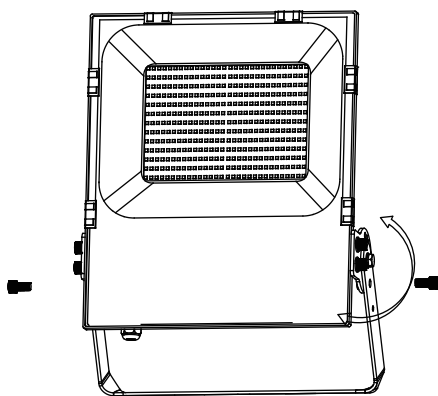

3. Loose the two fixing screws, then adjust the angle of support bracket.

4

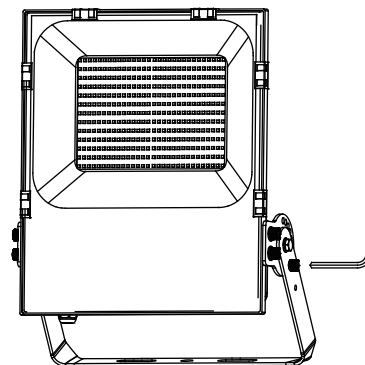

4. Fasten the two fixing screws.

5

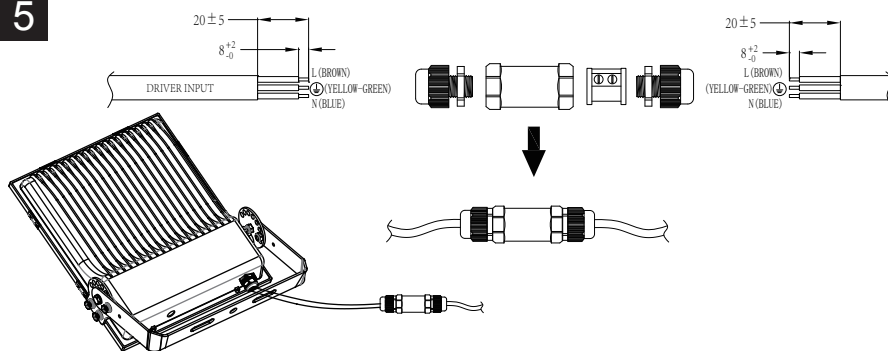

5, Individually connect the Live wire, Neutral wire and Ground wire of AC input wire to designated L, N, earth terminal of waterproof terminal. All cable terminations must be installed in accordance with the designed IP rating.

6

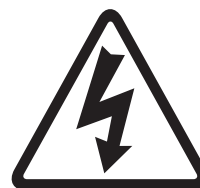

6. Reconnect mains supply.

CEOTIS ECLAIRAGE
C/O SOITEC
Parc technologique des fontaines
Chemin des Franques 38190
Bernin France
Email: contact@ceotis.fr
TEL: +33 (0)476 92 97 70